

RELEASE DATE:	9-Jun-10	BY:	MW
REVISION DATE:	23-Dec-15	REV	F
PRODUCT NAME:	EcoPark Locker		
PRODUCT NUMBER:	19500		

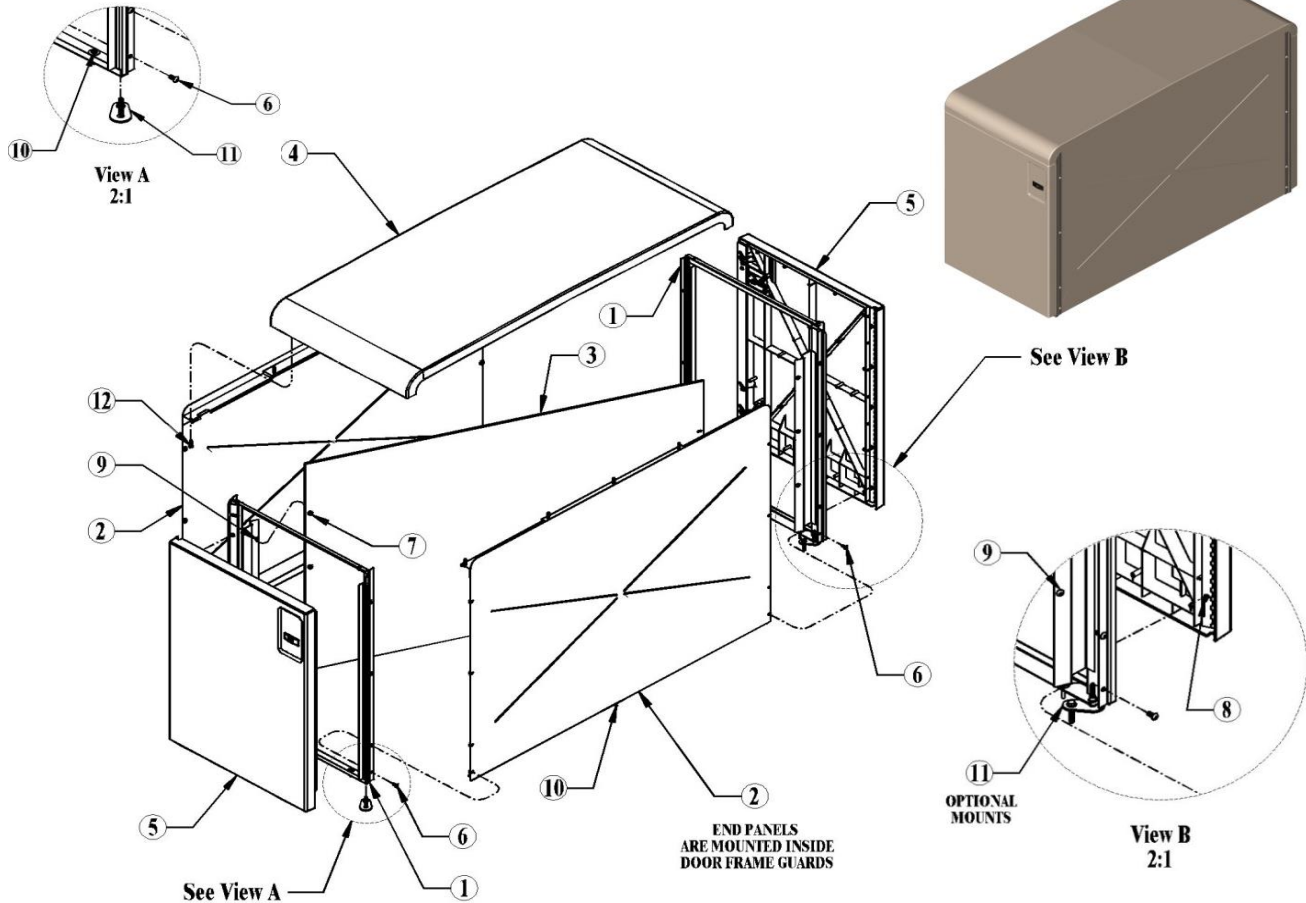

ECOPARK LOCKER ASSEMBLY INSTRUCTIONS

SCOPE: This installation instruction will describe how to assemble a single tier locker with two sided access and secure it to a solid base.



Tools Needed

- Battery powered drill motor
- 3/16" hex bit (4.5 metric)
- 7/32" hex bit (5.5 metric)
- 1/2" socket or end wrench (#13 metric)
- 9/16" socket or end wrench (#16 metric)
- Carpenter's square
- Torpedo level
- Concrete Epoxy

**Items 6 - 9
and 12
Kit # 19550**

Item	Qty	Description	Part #
1	2	Door Frame Assembly	19526
2	2	End Panel Weldment	19524
3	1	Partition (OSB) Panel	10101
4	1	Top Panel	10301
5	2	Door Panel Assembly	varies
6	16	3/8-16NC BHCS x 3/4" LG ZP	19569
7	6	5/16-18 NC whiz locknut ZP	19582
8	10	5/16-18 NC BHCS x 3/4" LG ZP	19581
9	6	5/16-18NC BHCS x 1" LG. ZP	17112
10	6	Drive Pin Lag Kit (std)	19571
11	4	Adj. Leveler kit (option)	19575
12	10	5/16-18NC x 1 1/4" HHMS ZP	10222

**ALWAYS OBSERVE POSTED SAFETY GUIDELINES WHEN ASSEMBLING THIS PRODUCT
ALWAYS WEAR SAFETY GLASSES.**

RELEASE DATE:	9-Jun-10	BY:	MW
REVISION DATE:	23-Dec-15	REV	F
PRODUCT NAME:	EcoPark Locker		
PRODUCT NUMBER:	19500		



ECOPARK LOCKER ASSEMBLY INSTRUCTIONS

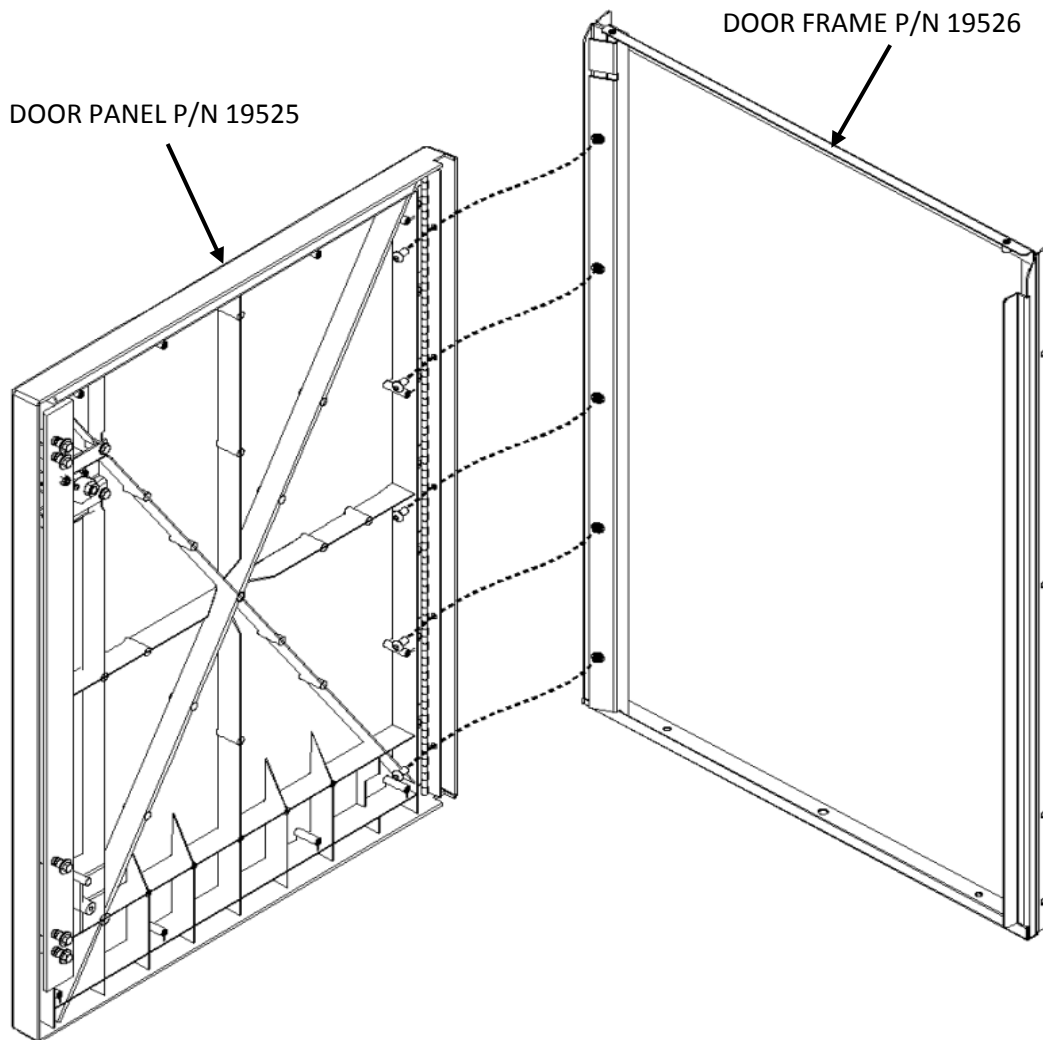

- 1 Align the hinge of the door panel assembly to the door frame assembly nutserts and fasten with 5/16-18NC BHCS X 3/4" screws (19581). There are (5) nutserts located on the door frame assembly. Repeat for the second door.

**ALWAYS OBSERVE POSTED SAFETY GUIDELINES WHEN ASSEMBLING THIS PRODUCT
ALWAYS WEAR SAFETY GLASSES.**

RELEASE DATE:	9-Jun-10	BY:	MW
REVISION DATE:	23-Dec-15	REV	F
PRODUCT NAME:	EcoPark Locker		
PRODUCT NUMBER:	19500		



ECOPARK LOCKER ASSEMBLY INSTRUCTIONS

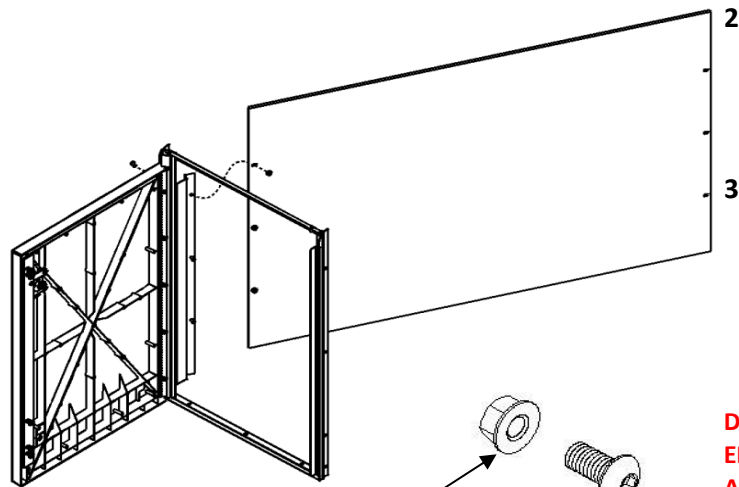

Attach the partition panel (10101) to one of the door and frame assembly using three 5/16-18NC X 1" screws (17112) and three 5/16-18NC whiz lock nuts (19582).

Attach the other door and frame assembly to the opposite end of the partition panel.

5/16-18NC Whiz Nut (19582)
5/16-18NC X 1" Screw (17112)

DO NOT TIGHTEN FASTENERS UNTIL THE END PANEL WELDMENTS (19524) HAVE BEEN ASSEMBLED AND SQUARED

- 4**
- A)** CAREFULLY position End Panel Weldment (19524) behind Door Frame Assembly flange (19526) at one end.
 - B)** At opposite Door Frame CAREFULLY pull the flange outward and rotate the End Panel Weldment behind the Door Frame flange.
 - C)** Fasten with 3/8-16NC X 3/4" BHCS (19569)

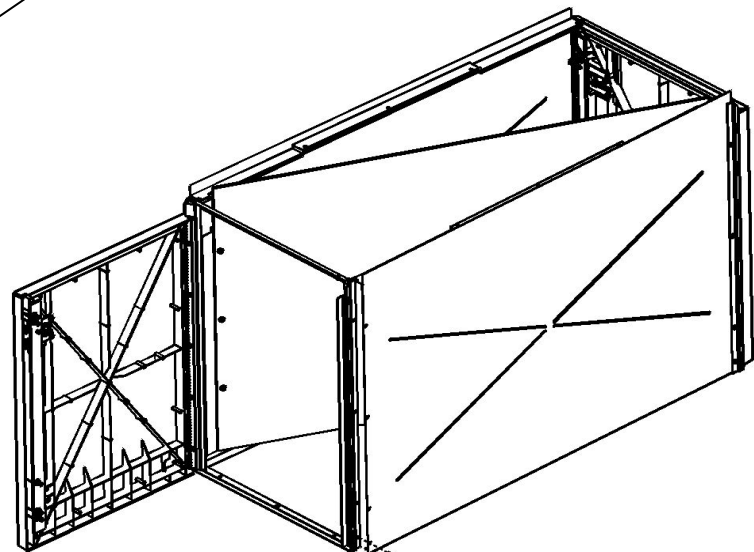

4 A) Insert end panels this direction
DO NOT SLIDE ON SURFACE

4 C) 3/8-16NC X 3/4" BHCS (19569)
(4) per end on each panel

4 B) Door Frame Assembly flange

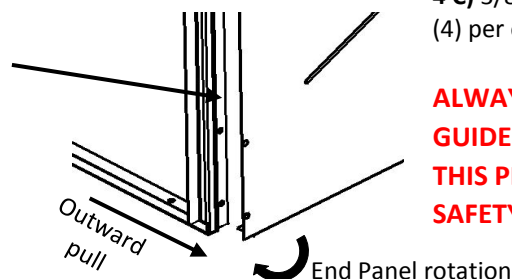

ALWAYS OBSERVE POSTED SAFETY GUIDELINES WHEN ASSEMBLING THIS PRODUCT. ALWAYS WEAR SAFETY GLASSES.

RELEASE DATE:	9-Jun-10	BY:	MW
REVISION DATE:	23-Dec-15	REV	F
PRODUCT NAME:	EcoPark Locker		
PRODUCT NUMBER:	19500		



ECOPARK LOCKER ASSEMBLY INSTRUCTIONS

MAKE SURE THE FRAME IS SQUARED PRIOR TO FASTENING THE TOP PANEL TO THE FRAME.

DO NOT overtighten the fasteners to the SMC plastic top panel. They should only be wrench snug!

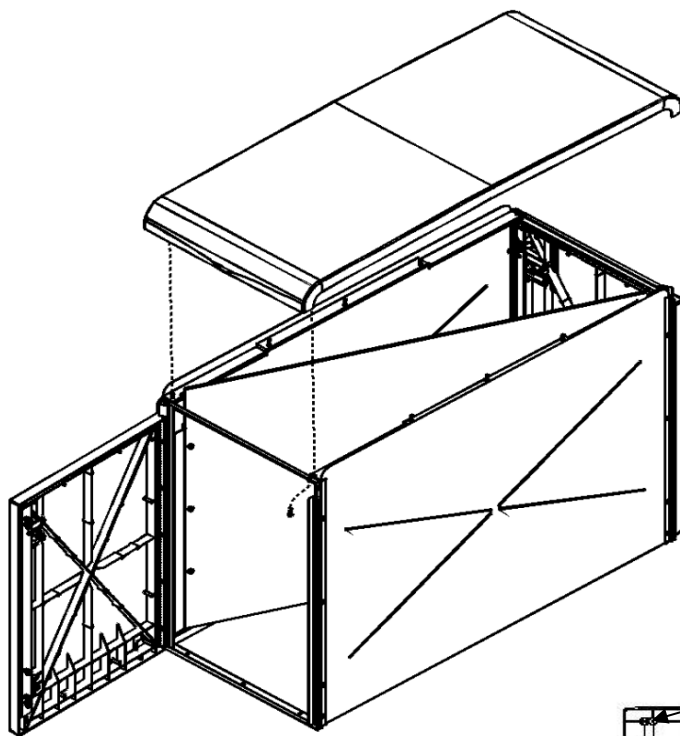

- 5 Align top panel bosses (10301) with end panel weldment holes (19524).
- 6 Using the 5/16-18NC screws (10222) fasten into the top panel through the end panel weldments holes.

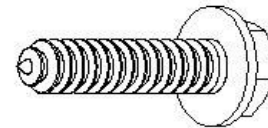

5/16-18NC HHMS X 1 1/4" LG. (10222)

Location of fastening bosses
(5) places per side

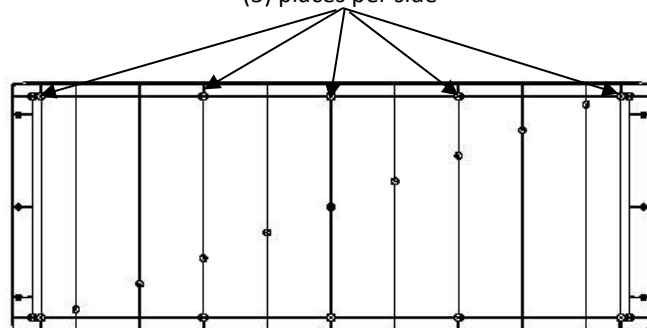

Bottom view of top panel (10301)

**ALWAYS OBSERVE POSTED SAFETY GUIDELINES WHEN ASSEMBLING THIS PRODUCT
ALWAYS WEAR SAFETY GLASSES.**

RELEASE DATE:	9-Jun-10	BY:	MW
REVISION DATE:	23-Dec-15	REV	F
PRODUCT NAME:	EcoPark Locker		
PRODUCT NUMBER:	19500		



ECOPARK LOCKER ASSEMBLY INSTRUCTIONS

Move the completed assembly to the desired location and anchor into the ground.
A 6' access lane is recommended around three (3) sides of unit.

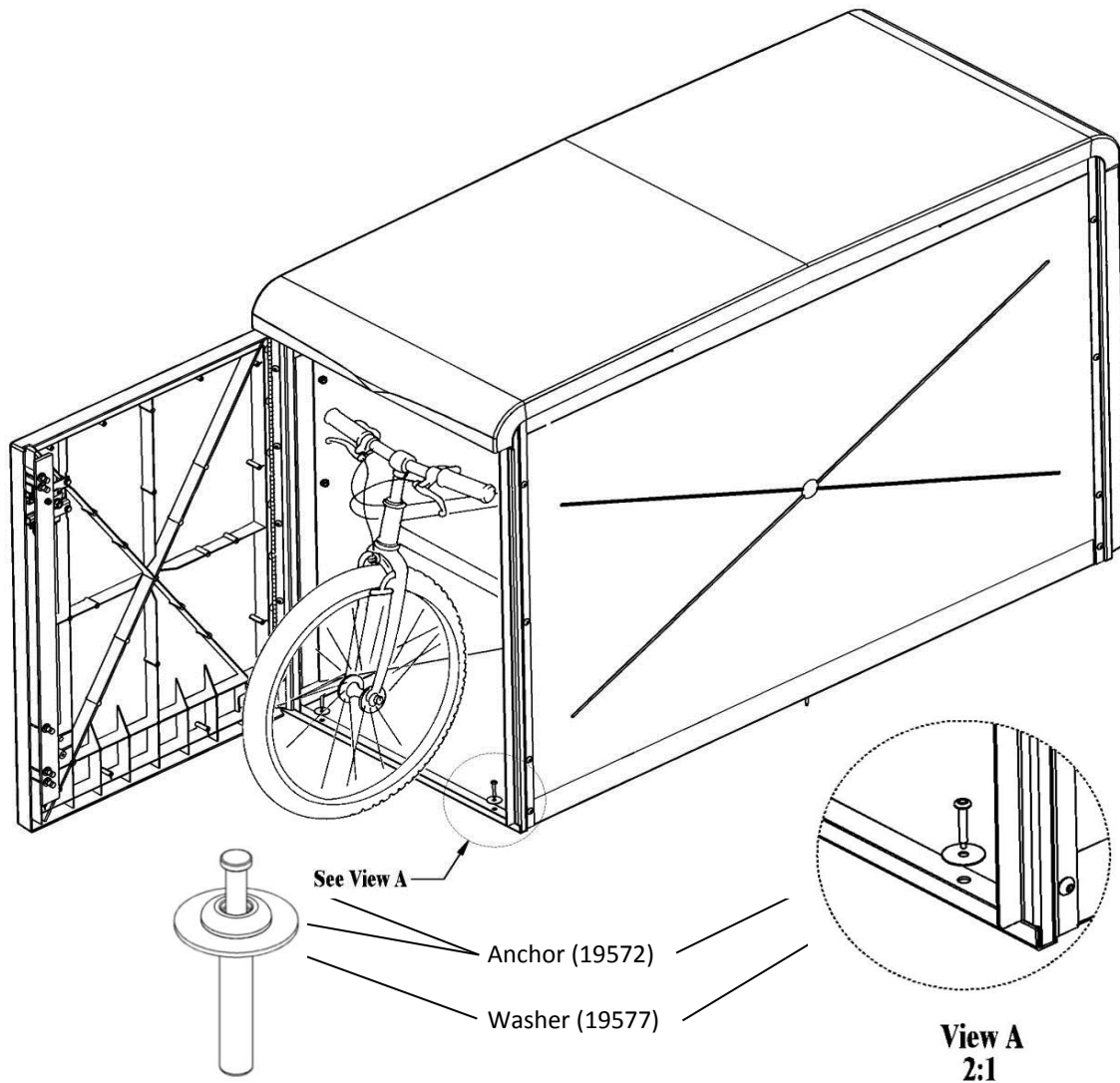

1/4" X 1-1/2" Hammer Zinc Alloy Anchor (19572) and 1/4" X 1" Diameter Washer (19577) for insertion into ground surface. Six (6) sets are used: (2) through door frames and (1) per end panel assembly.

Drill and insert the anchors in determined location. Use the concrete epoxy in the anchor holes and allow to set per manufacturer's instructions.

**ALWAYS OBSERVE POSTED SAFETY GUIDELINES WHEN ASSEMBLING THIS PRODUCT
 ALWAYS WEAR SAFETY GLASSES.**

REVISION LOG



REV	DATE	REVISION	BY	APPROVED	APPR DATE
		BLOCK OUT PRIOR CHANGES IN GRAY	INITIALS	NAME	
A	9-Jun-10	Initial Release	GM	MW	
B					
C					
D					
E	18-Oct-12	add bike graphic to page 5, change divider panel to partition panel. Eliminate the word thin from top panel description change top panel part # to 10301 (painted), clarified and confirmed hardware, fixed a couple of part # typos.			
F	23-Dec-15		MW		