

RELEASE DATE:	16-Jun-10	BY:	GM
REVISION DATE:	4-Nov-14	REV	bm
PRODUCT NAME:	Bike Check		
PRODUCT NUMBER:	12490		



## ASSEMBLY INSTRUCTIONS

### Bike Check Parking System

SCOPE: This installation instruction will describe the steps to assemble a Bike Check rack.

**NO TOOLS  
NEEDED!**



Item	Amt	Description	Part No.
1	8	Support Bar	12465
2	10	U-Bolt	12464
3	10	Inner Leg	12457
4	10	Outer Leg	12456
5	4	End Cap (1-1/4")	12466

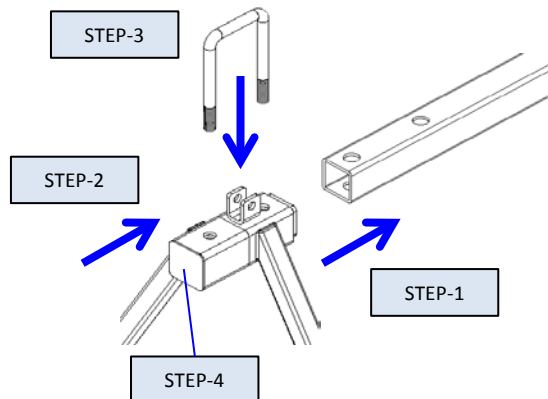
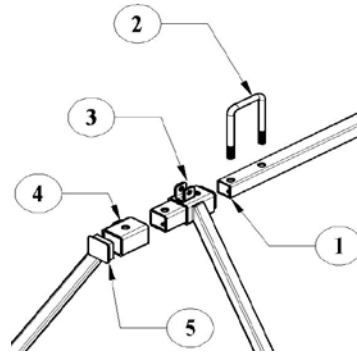

1. First, slide the Inner Leg (12457) onto the 8-ft long Support Bar (12465) and align the holes.

2. Slide the Outer Leg (12456) onto the Inner Leg (12457) and align the holes.

3. Insert the U-Bolt (12464) through the aligned holes to hold the end of the assembly together.

4. Tap the End Cap (12466) tightly into the Outer Leg.

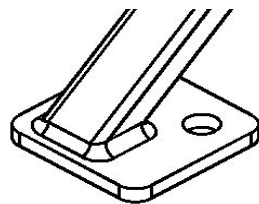

Foot Pads are provided with holes for staking

Apply your padlock or heavy "zip" tie to the hasp for security.

**ALWAYS OBSERVE POSTED SAFETY GUIDELINES WHEN ASSEMBLING THIS PRODUCT  
ALWAYS WEAR SAFETY GLASSES**

# ASSEMBLY INSTRUCTIONS



**Bicycles may be hung by the seat and locked directly to the Support Bar**



**Bicycles may be hung by the seat and locked to the optional Security Loop (12480)**

**Hang bicycles in opposite directions for greater density parking**



888.950.6531

[cyclesafe.com](http://cyclesafe.com)

[info@cyclesafe.com](mailto:info@cyclesafe.com)